

LH 8 SB100.120 SCG GALCU (200 087)

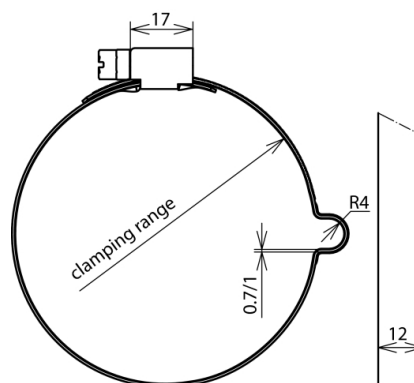
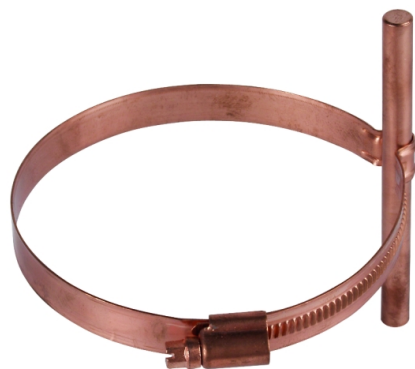

Figure without obligation

Part No.	200 087
Clamping range Ø pipe	100-120 mm
Conductor holder support Rd	8 mm
Conductor leading	fixed
Material of conductor holder	StSt / gal Cu
Screw	screw with worm drive SW7 mm
Material of grip head/screw	StSt / gal Cu
Fixing	with worm drive and bead
Weight	36 g
Customs tariff number	85389099
GTIN	4013364082342
PU	50 pc(s)

We reserve the right to introduce changes in performance, configuration and technology, dimensions, weights and materials in the course of technical progress. The figures are shown without obligation.