

LH 8 SB100.120 SCG V2A (200 089)

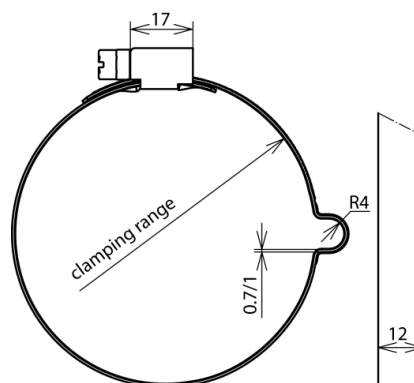

Figure without obligation



Part No.	200 089
Clamping range Ø pipe	100-120 mm
Conductor holder support Rd	8 mm
Conductor leading	fixed
Material of conductor holder	StSt
Screw	screw with worm drive SW7 mm
Material of grip head/screw	StSt
Fixing	with worm drive and bead
Weight	54 g
Customs tariff number	73269098
GTIN	4013364074729
PU	50 pc(s)

We reserve the right to introduce changes in performance, configuration and technology, dimensions, weights and materials in the course of technical progress. The figures are shown without obligation.